

WORLDLINE GIVES VISUALLY CHALLENGED USERS ACCESS TO TOUCHSCREEN PAYMENT INTERFACE

Easy access to
unattended payments
by VALINA

2 SEE THE MAGIC!
VOICI LA MAGIE!

A continuing increase in the number of unattended terminals using a touchscreen interface means an increasing demand to meet the needs of blind and partially sighted users.

The new VALINA from Worldline provides an accessible solution which enables blind and partially sighted users to enter their PIN easily, confidently and securely on its touch screen. The solution gives blind and partially sighted users easy access to all the advantages of a touchscreen interface. EVA-compliant, our VALINA can be quickly integrated in any kind of checkout kiosk, ticket kiosk and vending machine.

BRIDGE THE VISION GAP BY DEVELOPING ACCESSIBLE INTERACTION FOR BLIND PEOPLE

- Turn your payment terminal into an accessible point of interaction
- Improve inclusivity by helping visually impaired and partially sighted people to perform secure PIN entry
- Make sure you comply with the thematic approach of WCAG 2.0 rules



1

Perceivable

*Pictures as an alternative
of text, voice synthesis*



2

Operable

*Keyboard accessible,
navigable*



3

Understandable

Readable and predictable



4

Robust

Compatible for the future

Worldline



EMBOSSED TACTILE IDENTIFIERS

Providing embossed tactile identifiers replicates the keypad layout of a standard terminal and helps users enter their PIN

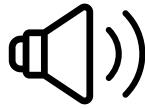

GUIDANCE

Implementing voice feedback guides the user through every step of the transaction, using an external USB speaker driven by VALINA or an external speaker integrated in the vending machine



GESTURAL INTERACTION

Using a single finger to locate and select the required key, then doubletap to confirm the selection, delivers a comfortable solution for the user

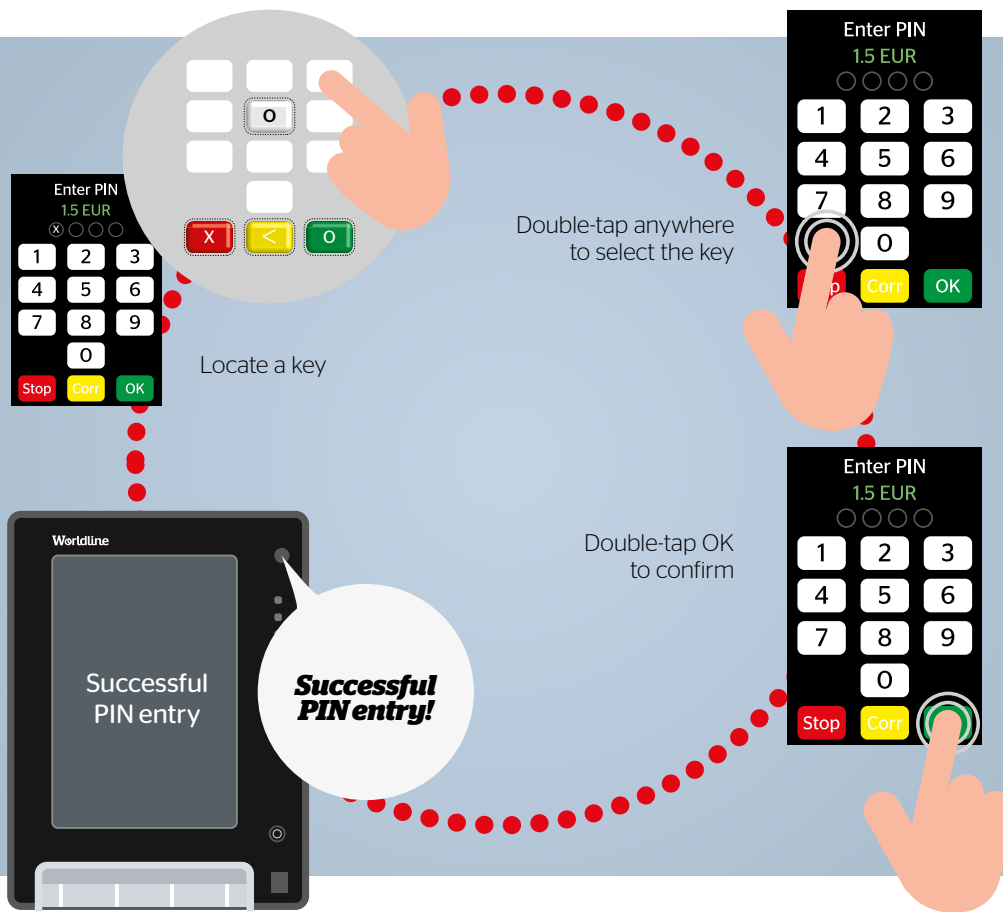

Find out more about what the VALINA can do for you



Your contact:

Luc Luyckx

Product Manager

luc.luyckx@worldline.com

About Worldline

Worldline [Euronext: WLN] is the European leader in the payment and transactional services industry. With innovation at the core of its DNA, Worldline core offerings include pan-European and domestic Commercial Acquiring for physical or online businesses, secured payment transaction processing for banks and financial institutions, as well as transactional services in e-Ticketing and for local and central public agencies. Thanks to a presence in 30+ countries, Worldline is the payment partner of choice for merchants, banks, public transport operators, government agencies and industrial companies, delivering cutting-edge digital services. Worldline activities are organized around three axes: Merchant Services, Financial Services including equensWorldline and Mobility & e-Transactional Services. Worldline employs circa 11,000 people worldwide, with estimated pro forma revenue of circa 2.3 billion euros on a yearly basis. Worldline is an Atos company.

